

**FUJIFILM**  
expect INNOVATION™

# SDTV ENG/EFP Professional Lenses



**A20x8.6B / S20x6.4B RM/ERM**

*Technology That Inspires...*

**FUJINON**

# A20x8.6B / S20x6.4B RM/ERM\*



LENS	A20x8.6B RM/ERM*	S20x6.4B RM/ERM*
Zoom Ratio / Format	20X / 2/3"	20X / 1/2"
Focal Length	8.6 to 172 mm	6.4 to 128 mm
Extender	(2X) 17.2 to 344 mm	(2X) 12.8 to 256 mm
Maximum Relative Aperture	F1.8 (to 115 mm) F2.7 (at 172 mm)	F1.4 (to 90 mm) F2.0 (at 128 mm)
Angular Field of View (Hor. x Vert. in °)	8.6mm 54° 11' x 41° 59' 172mm 2° 56' x 2° 12' (2X) 17.2mm 28° 42' x 21° 43' 344mm 1° 28' x 1° 06'	6.4mm 53° 08' x 41° 07' 128mm 2° 52' x 2° 09' (2X) 12.8mm 28° 04' x 21° 14' 256mm 1° 26' x 1° 04'
M.O.D. from Image Plane	0.9 m	0.9 m
Object Area (at Wide) at M.O.D. (at Tele)	8.6mm 866mm x 650mm 172mm 43mm x 33mm	6.4mm 846mm x 635mm 128mm 42mm x 32mm
(at Wide) (at Tele)	(2X) 17.2mm 433mm x 325mm 344mm 21mm x 16mm	(2X) 12.8mm 423mm x 317mm 256mm 21mm x 16mm
Filter Size	ø 82 mm P=0.75	ø 82 mm P=0.75
Weight RM	1.4 kg	1.4 kg
ERM	1.5 kg	1.5 kg
Features	Inner Focus	Inner Focus

\*ERM version with extender

## ACCESSORIES: HD & SD ENG/EFP

## ACCESSORIES: HD & SD ENG/EFP

### PROFESSIONAL REAR CONTROL KITS

MS-01 Manual Focus/Servo Zoom

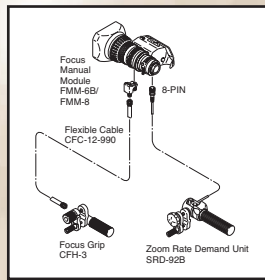

MM-01 Manual Focus/Manual Zoom  
Not available on S16x7.3

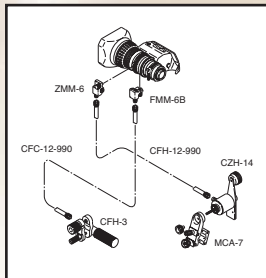

SS-01 Servo Focus/Servo Zoom  
Not available on S16x7.3

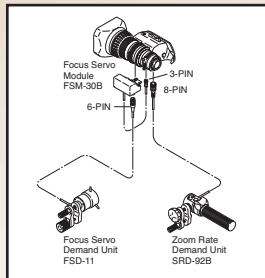

\*Specify camera type.

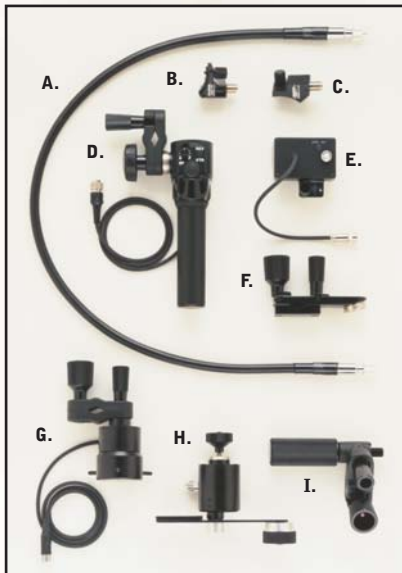

- A. CFC-990 Flex Cable
- B. FMM-6B/FMM-8\* Focus Manual Module
- C. ZMM-6 Zoom Manual Module
- D. SRD-92B Zoom Demand
- E. FSM-30B Focus Servo Module
- F. MCA-7 Mounting Clamp
- G. FSD-11 Focus Demand
- H. CZH-14 Zoom Handle
- I. CFH-3 Focus Handle

\*FMM-8 for use with S16x7.3



Wide Attachment (WAT)



Fish-Eye Attachment (F-AT)

## BROADCAST LENS CONVERTERS

Model	Type	ø Size	Converter*	Mag.	Converted Focal Length (mm)	M.O.D. (m)	Weight (kg)
A18x7.6	TELE	85 mm	TCV-85C	1.6x	137.0→219.0	1.54	1.15
ERM/ERD	WIDE	85 mm	WCV-85C/-L85	0.8x	7.6→6.1	0.38	1.09/0.57
	WIDE	85 mm	WAT-85C	0.7x	7.6→5.3	—	0.55
	FISHEYE	85 mm	F-AT85C	Approx. 0.55x	—	—	0.62
	RATIO	82 mm	RCV-82SC	0.82x	7.60→6.20	0.40	0.25
A23x7.6	TELE	100 mm	TCV-10C	1.6x	175.0→280.0	2.05	1.06
ERM/ERD	WIDE	100 mm	WCV-100D	0.8x	7.60→6.10	0.51	1.09
	WIDE	100 mm	WAT-100C	0.7x	7.60→5.30	0.39	0.00
	FISHEYE	100 mm	F-ATH100C	0.55x	7.60→4.20	0.24	0.55

## PROFESSIONAL LENS CONVERTERS

Model	Type	ø Size	Converter	Mag.	Converted Focal Length (mm)	M.O.D. (m)	Weight (kg)
A13x6.3	TELE	85 mm	TCV-85C	1.6x	82.0→131.2	1.02	1.15
RM/ERM	WIDE	85 mm	WCV-85C	0.8x	6.3→5.0	0.26	1.09
	WIDE	85 mm	WAT-85C	0.7x	6.3→4.4	—	0.55
	FISHEYE	85 mm	F-AT85C	Approx. 0.55x	—	—	0.62
A20x8.6	TELE	85 mm	TCV-85C	1.6x	172.0→275.2	2.30	1.15
RM/ERM	WIDE	85 mm	WCV-85C/-L85	0.8x	8.6→6.9	0.58	1.09/57
	WIDE	85 mm	WAT-85C	0.7x	8.6→6.0	—	0.55
	RATIO	82 mm	RCV-82SC	0.82x	8.6→7.1	0.61	0.25
S13x4.6	TELE	85 mm	TCV-85C	1.6x	60.0→96.0	1.02	1.03
RM/ERM	WIDE	85 mm	WCV-85C	0.8x	4.6→3.7	0.26	1.09
	WIDE	85 mm	WAT-85C	0.7x	4.6→3.2	—	0.55
	FISHEYE	85 mm	F-AT85C	Approx. 0.55x	—	—	0.62
S17x6.6	TELE	85 mm	TCV-85C	1.6x	114→182.4	2.30	1.15
RM	WIDE	85 mm	WCV-85C	0.8x	6.6→5.3	0.58	1.09
	WIDE	85 mm	WAT-85C	0.7x	6.6→4.6	—	0.55
	FISHEYE	85 mm	F-AT85C	Approx. 0.55x	—	—	0.62
S20x6.4	TELE	85 mm	TCV-85C	1.6x	128.0→204.8	2.30	1.15
RM/ERM	WIDE	85 mm	WCV-85C/-L85	0.8x	6.4→5.1	0.58	1.09/57
	WIDE	85 mm	WAT-85C	0.7x	6.4→4.5	—	0.55
	FISHEYE	85 mm	F-AT85C	Approx. 0.55x	—	—	0.62

\*TCV/WCV are zoom thru type \*\*ø 95mm P-1 screw on type  
Wide attachment and fisheye attachment can be used at WIDE END.  
Number of M.O.D. is at wide end.

For Sales Contact Information go to  
**www.Fujinon.com**